

MICROFILMED

FILED  
GREENVILLE, S.C.  
JUN 19 9 20 AM '85  
DONNIE W. WERSLEY  
R.M.C.

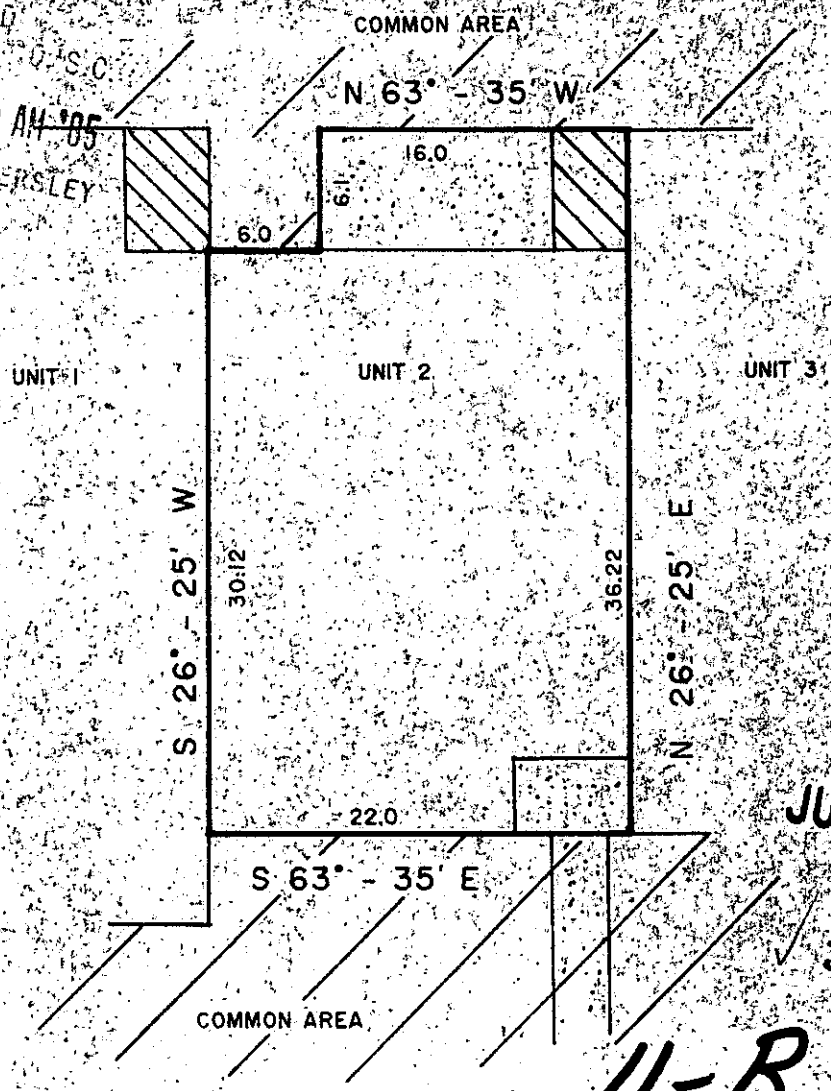
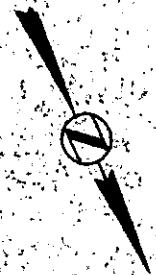

JUN 19 1985

38673

11-R-8

This is to certify that on June 18, 1985, I surveyed the property shown on this plat, known as Unit 2 on Plat of Furman Place Residences, Building A, recorded in the R.M.C. Office of Greenville County, in Plat Book \_\_\_ at Page \_\_\_, and that the property lines, walls and buildings are as shown hereon, that the building located on said lot does not encroach or project on adjacent streets or property, and that no adjacent walls or buildings encroach or project on said premises, and that no utility lines R/W's cross this property, except as shown hereon. This property is not located in a Designated Flood Hazard Area.

*Frederick E. Landrith*  
 Frederick E. Landrith RLS 9545

THIS PROPERTY IS SUBJECT TO ANY AND ALL RIGHTS OF WAY AND EASEMENTS OF RECORD.

**LANDRITH SURVEYING**  
 Land Surveys • Topographical Maps  
 Construction Layout

4418 WHITE HORSE ROAD  
 GREENVILLE, SOUTH CAROLINA



**STATE of SOUTH CAROLINA**  
**COUNTY of GREENVILLE**

FURMAN PLACE  
 BUILDING A, UNIT 2

SURVEY FOR  
 JAMES C. SUTTLES

SURVEYED BY FEL CK'D BY JMW  
 DRAWN BY TLM DATE 06/18/85

SEAL

JUN 19 1985  
 PROJECT NO 65-307